



Keyboard Shortcuts

Changing SpinFire Ultimate Default Settings

To do this...	Do this...
Select the language used by SpinFire Ultimate	CTRL-ALT+F1

Controlling the View (3D Documents)

Selection	To do this...	Do this...	If available, do this...
 Rotate Mode	Rotate	Left-Mouse-click+Drag	
	Zoom <i>out</i>	CTRL+Left-click+Drag <i>up</i>	Rotate middle mouse wheel up
	Zoom <i>in</i>	CTRL+Left-click+Drag <i>down</i>	Rotate middle mouse wheel down
	Pan	SHIFT+Left-click+Drag	
 Zoom Mode	Zoom <i>out</i>	Left-click+Drag <i>up</i> <i>or</i> CTRL+Left-click+Drag <i>up</i>	Rotate middle mouse wheel up
	Zoom <i>in</i>	Left-click+Drag <i>down</i> <i>or</i> CTRL+Left-click+Drag <i>down</i>	Rotate middle mouse wheel down

	Pan	SHIFT+Left-click+Drag	Click middle mouse button/wheel+Drag
	Rotate	N/A	
	Pan	Left-click+Drag or SHIFT+Left-click+Drag	Click middle mouse button/wheel+Drag
Pan mode			
	Rotate	N/A	
	Zoom <i>out</i>	CTRL+Left-click+Drag <i>up</i>	Rotate middle mouse wheel up
	Zoom <i>in</i>	CTRL+Left-click+Drag <i>down</i>	Rotate middle mouse wheel down
	Copy image of 3D work space to clipboard	Ctrl-C	
	Toggle the shortcut toolbar on/off	Ctrl-T	
F6	Cycle through standard view settings		
<CTRL> Z	Perform UNDO		

Controlling the View (2D Documents)

To do this...	Do this...	If available, do this...
Pan	Left-click+Drag	
Zoom <i>out</i>	CTRL+Left-click+Drag <i>up</i>	Rotate middle mouse wheel up
Zoom <i>in</i>	CTRL+Left-click+Drag <i>down</i>	Rotate middle mouse wheel down
Copy image of 2D work space to clipboard	Ctrl-C	
Toggle the shortcut toolbar on/off	Ctrl-T	

Working with Cross Sections

To do this...

Rotate a cross-section plane on an axis

Do this...

Right-click on the plane to select

Select Enable Dragging on the context menu

Click left mouse on yellow rotate grip+Drag

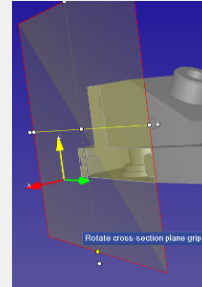

Slide a cross-section plane along an axis

Right-click on plane to select

Select Enable Dragging on the context menu

Click left mouse on yellow slide grip+Drag

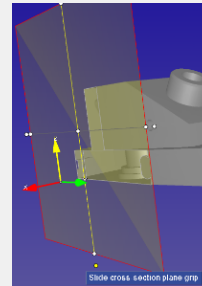

To position a plane on a model

Right-click on plane to select

Select Enable Dragging on the context menu

With the left mouse button, click anywhere on the plane and drag

Selecting Parts and Surfaces

To do this...	Do this on the assembly tree...	Do this in the viewport...
Select a part on a model	Left-click	Right-Click
Select multiple parts on a model	SHIFT+Left-click	CTRL+Right-Click <i>or</i> SHIFT+Right-click+Drag red selection box to encompass parts
To add parts to a selection		CTRL+SHIFT+Right-Click+Drag red selection box to encompass parts
Deselect all parts	Right-click on background	
Deselect all except chosen part	Right-click on chosen part	

Menus

To do this...	Do this...
View zoom context menu	Right-click on viewport background
View assembly context menu	Select part or model from the assembly list <i>or</i> the viewport, then Right-click